

FORM B - BUILDING

Massachusetts Historical Commission  
 80 Boylston Street  
 Boston, Massachusetts 02116

Assessor's number

70-238

USGS Quad

Marlborough

Area(s)

Form Number

121



te the  
 photo.  
 ative here

s within  
 al  
 l streets,  
 eparate

sheet if space is not sufficient here. Indicate north.

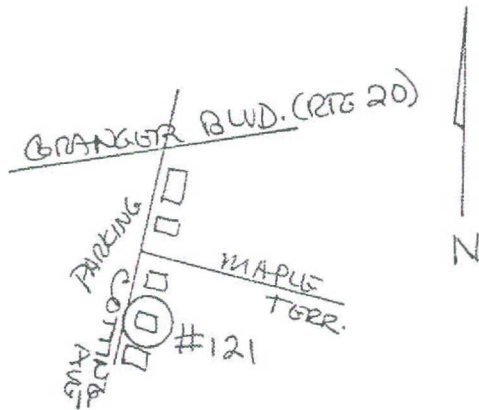

Town Marlborough

Place (neighborhood or village) \_\_\_\_\_

Address 62 Cotting Ave

Historic Name McCarty House

Uses: Present offices

Original dwelling

Date of Construction ca 1888

Source Maps; style

Style/Form Queen Anne

Architect/Builder unknown

Exterior Material:

Foundation granite

Wall/Trim asbestos shingle

Roof slate

Outbuildings/Secondary Structures \_\_\_\_\_

none

Major Alterations (with dates) \_\_\_\_\_

some windows replaced

Condition good

Moved [X] no [ ] yes Date N/A

Acreage less than one acre

Setting In line of late-19th-century houses

overlooking parking lot and Rte 85. Field-

stone retaining wall at front

Recorded by Anne Forbes

Organization for Marlboro Hist Comm

Date 4/30/94

## BUILDING FORM

### ARCHITECTURAL DESCRIPTION *see continuation sheet*

*Describe architectural features. Evaluate the characteristics of this building in terms of other buildings within the community.*

The most well-preserved of the 1880's-'90's houses on lower Cotting Avenue, #62 is a stylish, two-story Queen Anne residence embellished with Eastlarkian details and some elements of the earlier Stick Style. It has a high hipped roof, with one section extending forward to shelter a balcony at the northwest facade corner. Beside it is a broad gabled bay projecting forward over a wraparound porch which extends to a two-story polygonal bay on the south side. The porch has sawcut brackets, balustrade, and skirt, and a gable over the entry stairs that is embellished with pierced brackets, a pierced and incised verge board, and a lathe-turned frieze screen. Similar detailing appears in the balcony. All gables of the house have decorative, sawcut gable screens and brackets. The wall of the main facade gable is also divided by horizontal and vertical stickwork. The windows have flat surrounds, and some retain leaded sash with triangular panes. A similar diagonal leaded detail appears in a ring around a large plate-glass "picture" window in the first story facade and in two stair windows in the north wall. The main entry has a large double-leaf glass-and-panel door with large glass lights with frosted panes at the upper and lower edge.

### HISTORICAL NARRATIVE *see continuation sheet*

*Explain history of the building. Explain its associations with local (or state) history. Include uses of the building, and the role(s) the owners/occupants played within the community.*

This house and its neighbors on lower Cotting Avenue stand on land that until the 1880's was part of the property associated with the old Cotting Hotel, which stood on the south side of Main Street nearly opposite the Thayer Tavern (see Form #112.) Beginning in the 1880's, the land was divided and sold, and Cotting Avenue was laid out through it to the railroad. In 1889, Rice & Hutchins expanded their shoe business into a new factory on the west side of the street, on the site of the present parking lot, and a line of houses was gradually built along the east side.

This house was the home of **Thomas McCarty**, a stonemason. Several other family members lived here over the years, as well, including John d. McCarty, a musician, Agnes E., and Katherine T.

Clothier Michael J. McCarthy boarded here for a while after the 1886 death of his wife. (See Form #170.)

### BIBLIOGRAPHY and/or REFERENCES *see continuation sheet*

Maps and Atlases: 1889; Sanborns.  
Marlborough directories.

Recommended for listing in the National Register of Historic Places. *If checked, a completed National Register Criteria Statement form is attached.*